

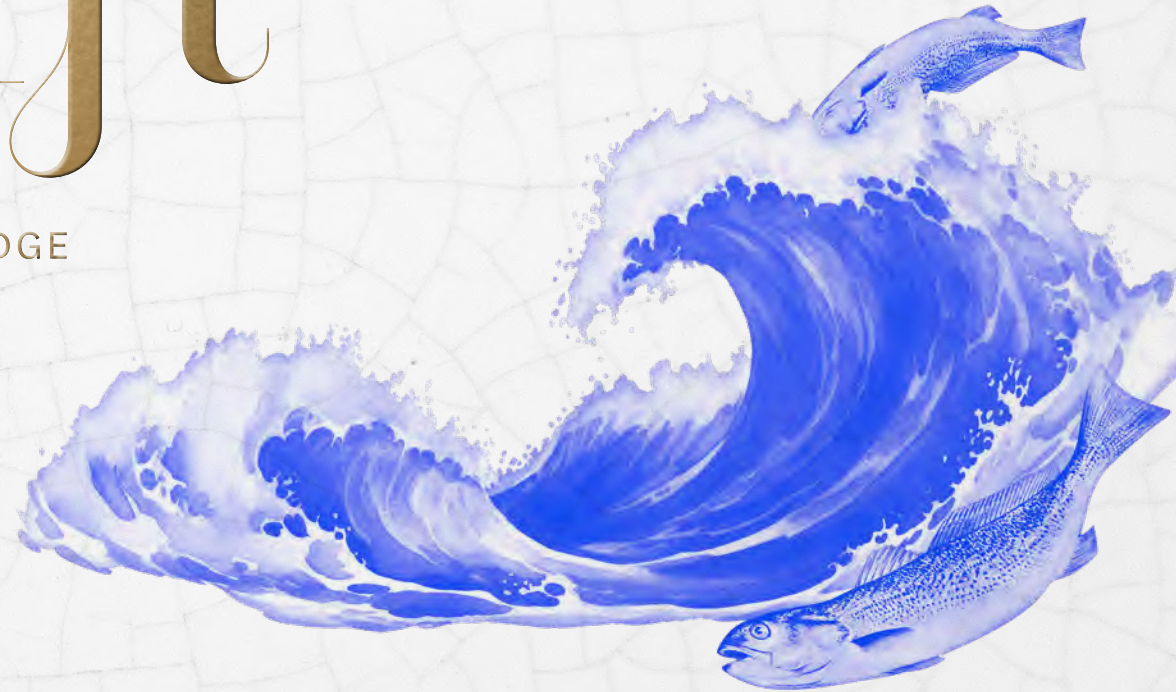

THE

# delft

LONDON BRIDGE



# AVAILABILITY

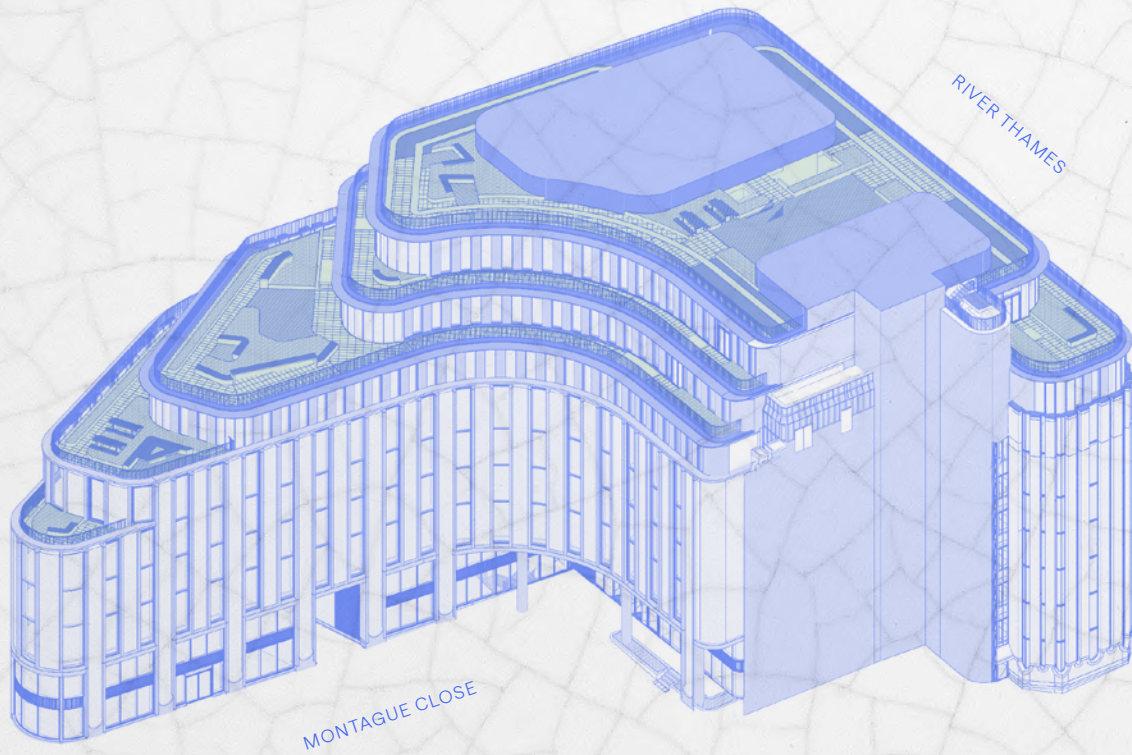

All areas indicative

Floor	NIA SQ FT	NIA SQ M	Terraces SQ FT	Terraces SQ M
Communal Terrace	-	-	5,996	557
8th	8,821	819	2,153	200
7th	LET			
6th	LET			
5th	LET			
4th	17,760	1,650		
3rd	17,760	1,650		
2nd	17,760	1,650		
1st West	10,463	972		
1st East	LET			
Ground West	6,616	615		
Ground East	LET			
Reception	2,450	228		
Lower Ground	6,889	640		
<b>Total</b>	<b>86,069*</b>	<b>7,996</b>	<b>8,149</b>	<b>757</b>

\*Not including reception NIA

# G

Reception

2,450 SQ FT  
228 SQ M

West

6,616 SQ FT  
615 SQ M

East

LET

- Reception
- Office
- Core
- Public Realm
- Retail
- Let

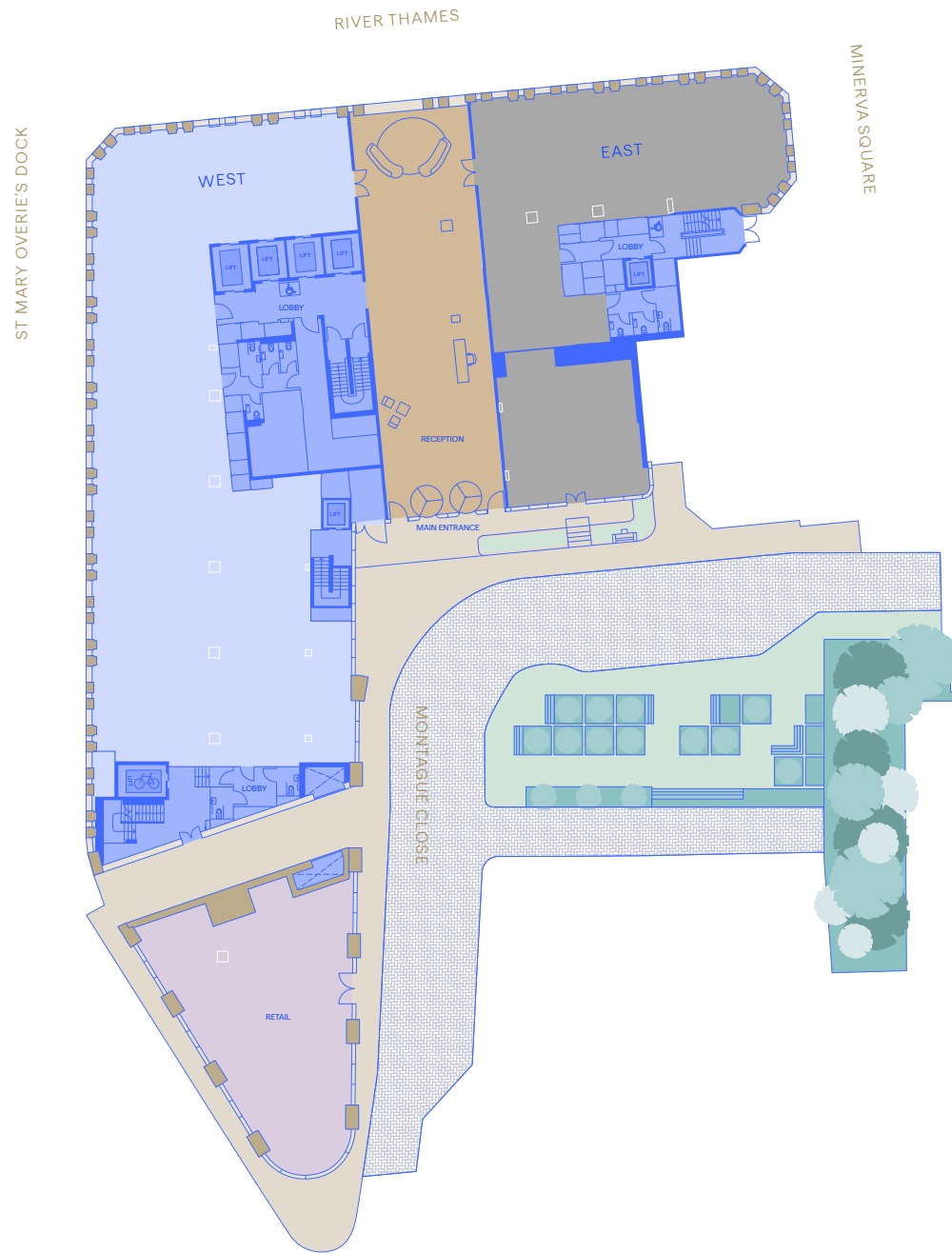



West

10,463 SQ FT  
972 SQ M

East

LET

- Void
- Office
- Core
- Let

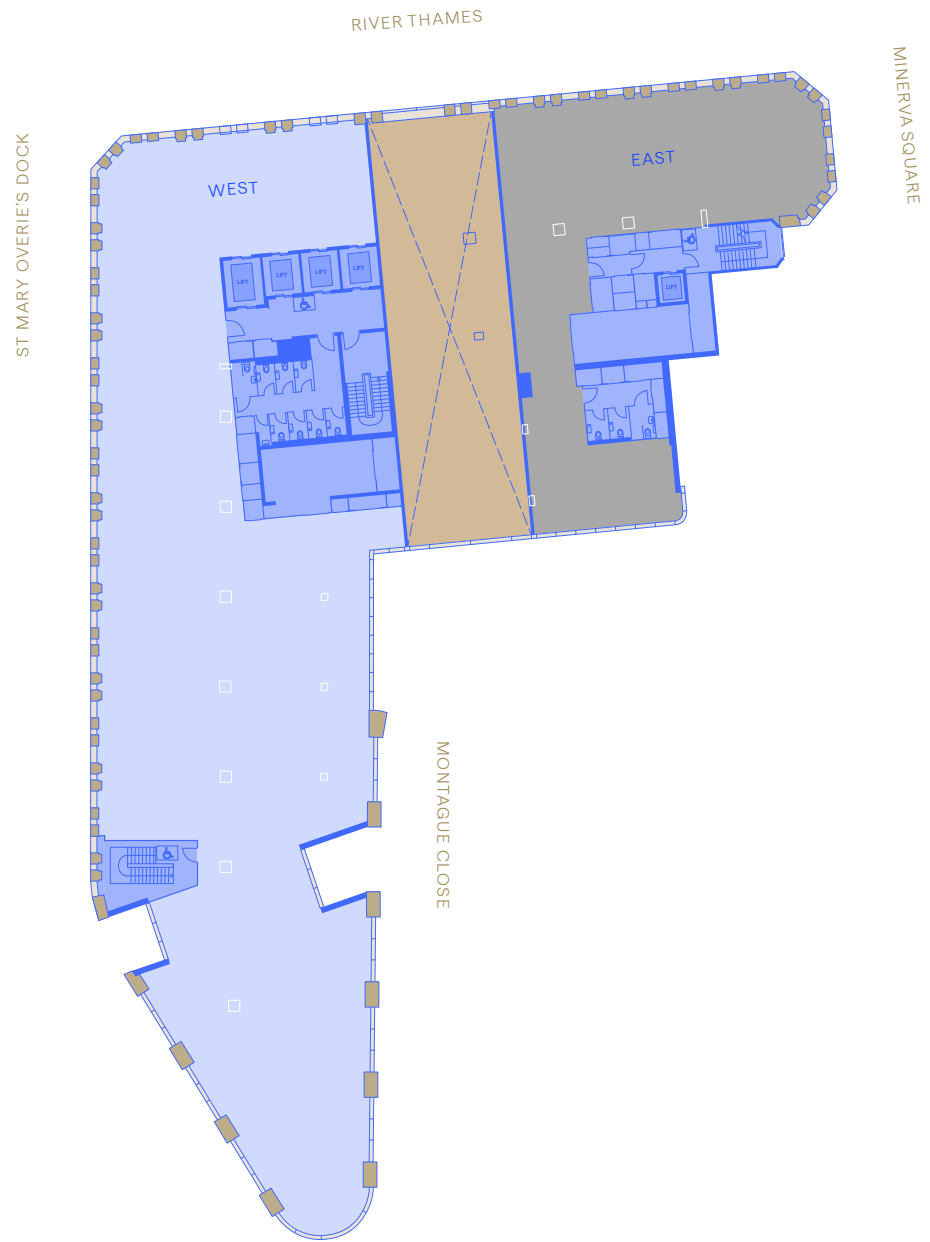

# 2-4

*Second to Fourth*

17,760 SQ FT  
1,650 SQ M

- Office
- Core

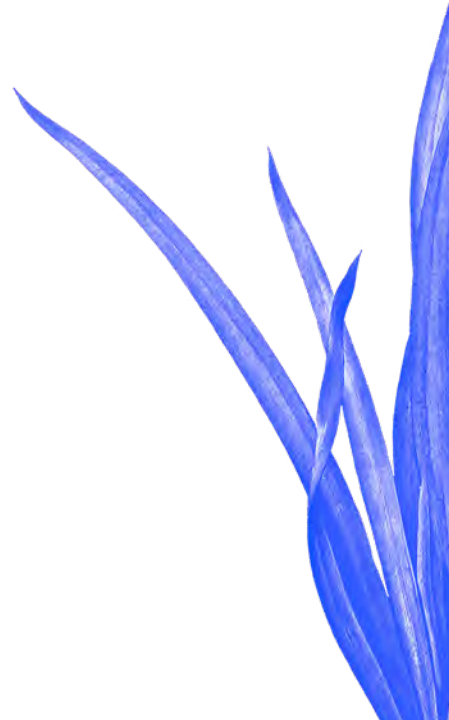
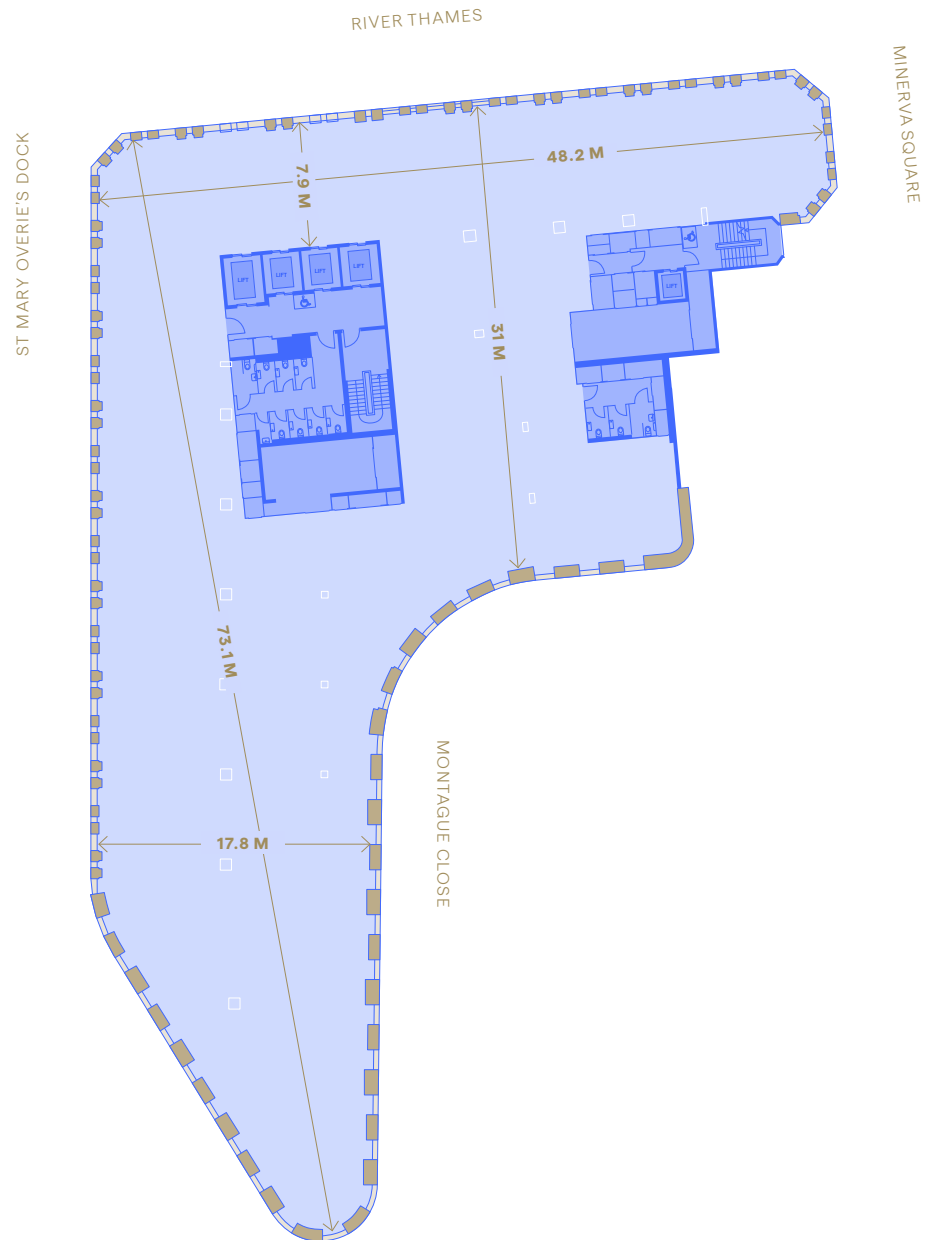



Office

8,821 SQ FT  
819 SQ M

Terrace

2,153 SQ FT  
200 SQ M

- Office
- Core
- Terraces

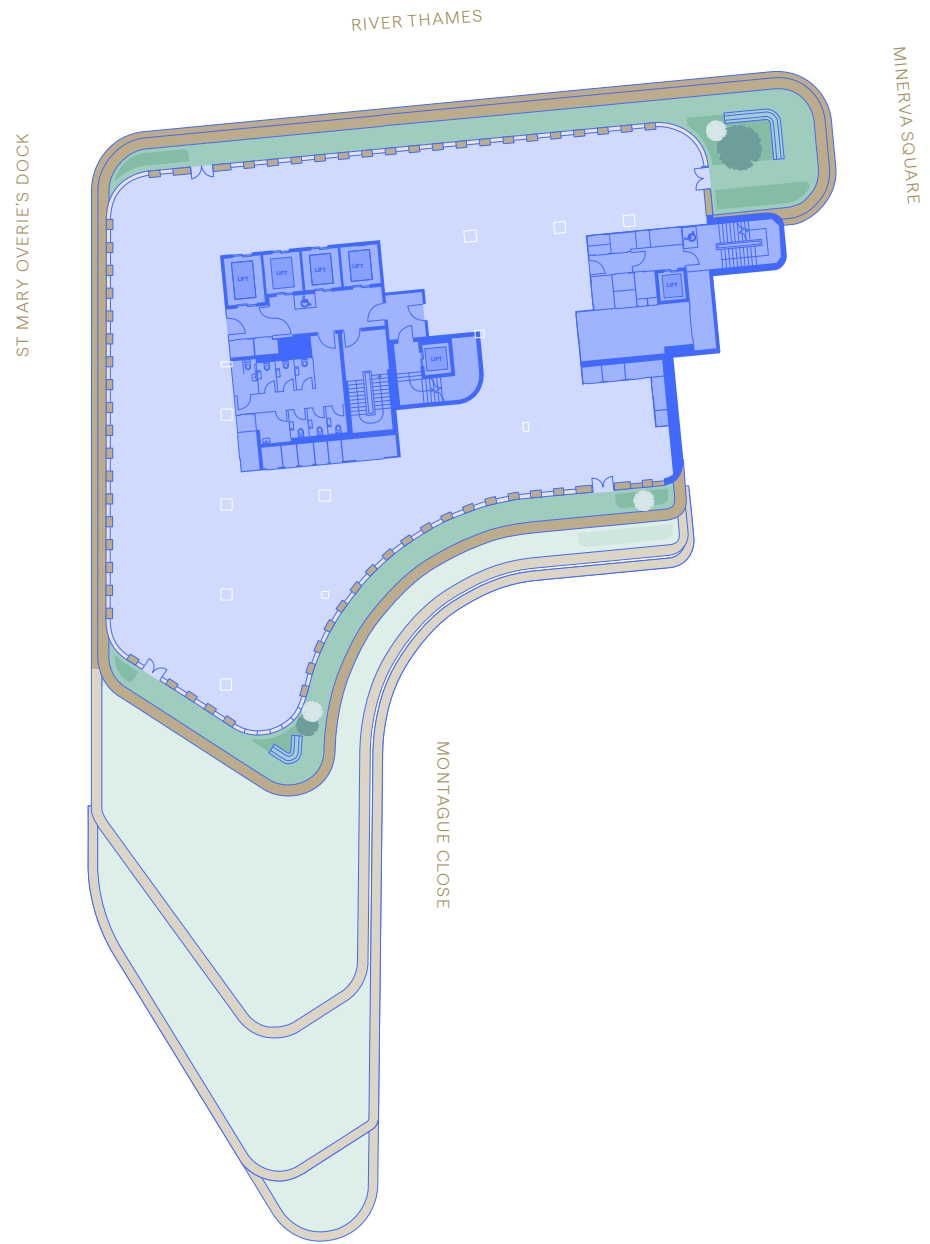

# 9

## Communal terrace

5,996 SQ FT  
557 SQ M

- Core
- Terraces

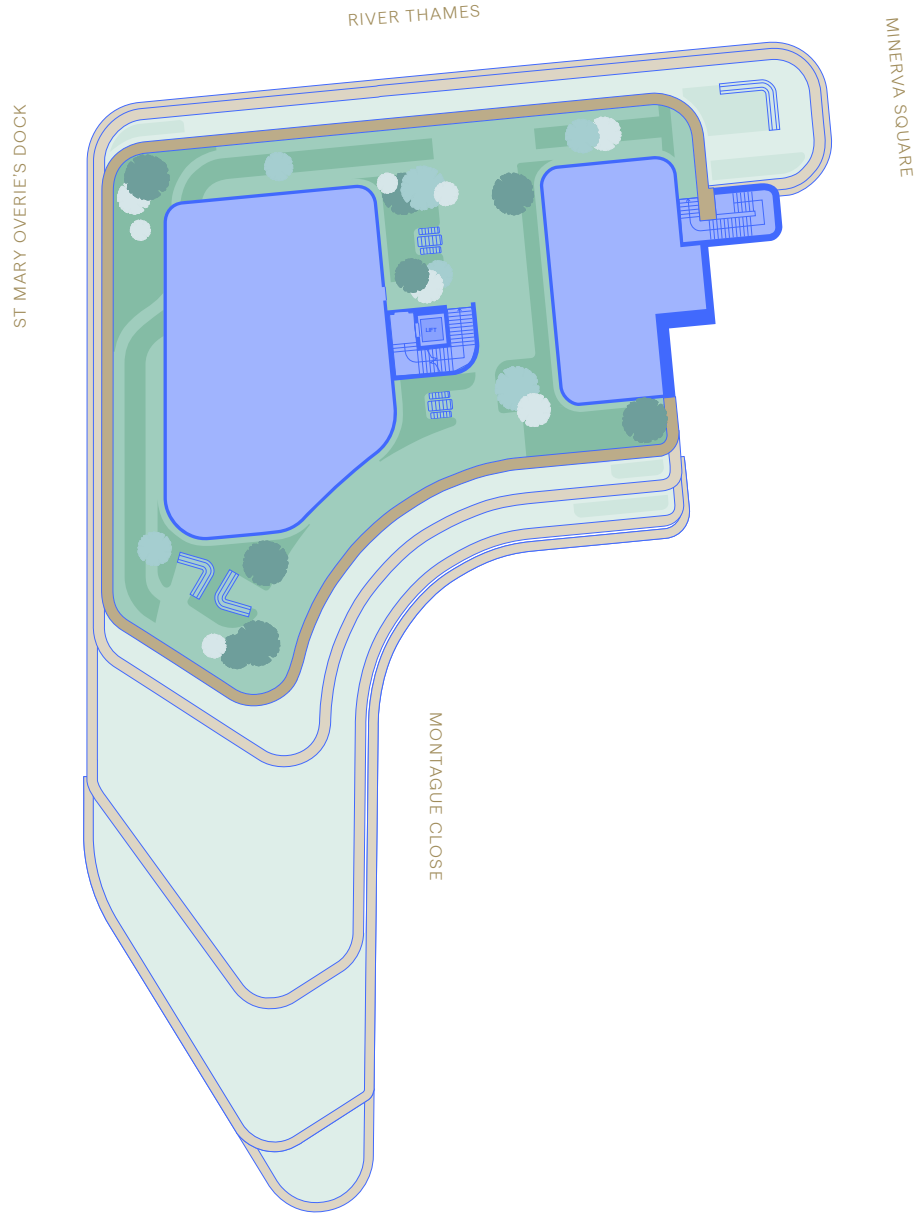

# ENQUIRIES

CBRE

SAVILLS

GPE

**DAVE PEROWNE**

+44 (0)7739 814 720

david.perowne@cbre.com

**ADAM COSGROVE**

+44 (0)7500 872 851

adam.cosgrove@cbre.com

**BRIAN ALLEN**

+44 (0)7972 000 215

bmallen@savills.com

**PHILIP PEARCE**

+44 (0)7870 555 727

ppearce@savills.com

**ANDREW WEDDERSPOON**

+44 (0)7807 999 363

awedderspoon@savills.com

**RICHARD CARSON**

+44 (0)7436 030 120

richard.carson@gpe.co.uk

**MARC WILDER**

+44 (0)7789 813 202

marc.wilder@gpe.co.uk